



# VisiDiff™ Proofing Automation Software

## Automatically Detect Minor Changes Made to an Existing Document Design

### Verify Intended Changes and Unveil Inadvertent Changes

One of the most embarrassing (and costly) problems in prepress is finding an artwork error after a minor-change-repeat job goes to press. A simple edit to a line of text in a paragraph can sometimes cause the next line to break and overset on another object. When objects are moved, resized, re-colored, or altered in any way, other objects are sometimes affected in unexpected ways.

Proofreading a complex job is time-consuming and tedious, and when tight deadlines are approaching, errors are even more difficult to see. That's where VisiDiff comes in.

Starting with PDF files from the "Before" and "After" versions of a document, VisiDiff identifies, highlights, and links all the changed areas so that a Proofreader can quickly validate the job. VisiDiff can find extremely small changes to documents, with the ability to detect that a 6 point Helvetica period "." was replaced by a comma ",".

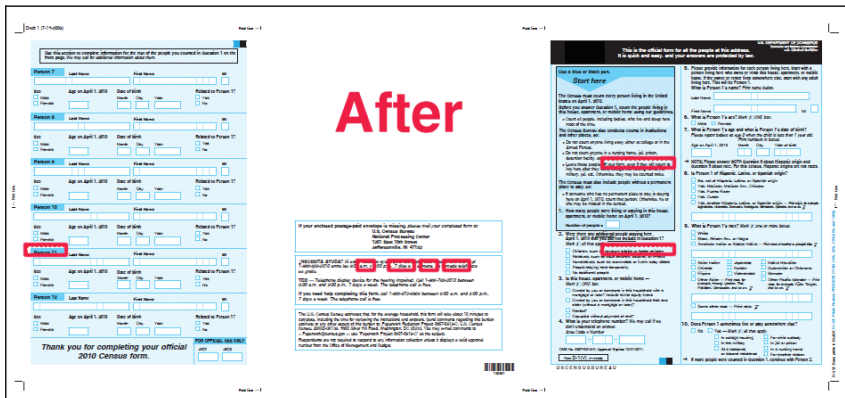
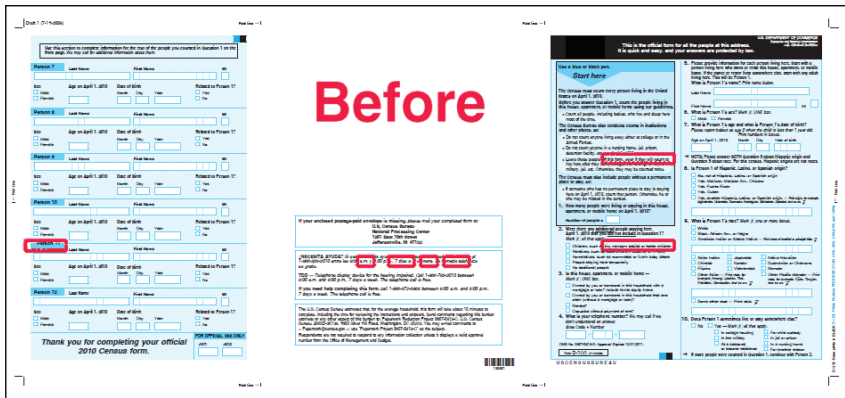

Clients with the free Adobe Reader can click to automatically zoom to each change zone and toggle the "before" and "after" views to verify that the changes are correct.

**COMPARE**

Run New Compare

**SUMMARY**

Page #	Difference Pos	Size
1-1	792, 665	90, 217
1-2	1368, 539	162, 391
1-3	54, 341	50, 157
1-4	1368, 341	162, 1189
1-5	810, 305	36, 541
1-6	392, 305	54, 521
1-7	954, 305	36, 685
1-8	1008, 305	54, 757

---

**HISTORY**

Date/Time	Before	After	Output	Status
09/02/09 23:20	Before0-1[V]_1_1_proof.pdf	After0-1[V]_1_1_proof.pdf	After0-1[V]_1_1_proof_090902232003.pdf	Success
09/02/09 22:57	Before0-1[V]_1_1_proof.pdf	After0-1[V]_1_1_proof.pdf	After0-1[V]_1_1_proof_090902225722.pdf	Success

### Pixel-by-Pixel Comparison for Proofing Assurance

VisiDiff first makes a high resolution bitmap out of the Before and After versions of a printable document. Then the bits are compared pixel-by-pixel for differences in hue, saturation, and lightness. When a difference is found, a "change zone rectangle" overlay is created as an electronic form field positioned on top of the documents.

The rectangles grow to surround the extent of the changed area, and then are auto-sized to be at least one-half inch on each side, and colored bright red. The XY locations of the change zones are then inserted into a VisiDiff Job Approval Form so that the graphic designer can click to instantly zoom to see each before/after change on the document. Each change zone can be checked as Approved or Not Approved before clicking to examine the next zone.

Zone Number	Approve Changes	Changes Not Approved	Comments
Zone 1	<input checked="" type="checkbox"/>	<input type="checkbox"/>	
Zone 2	<input checked="" type="checkbox"/>	<input type="checkbox"/>	
Zone 3	<input checked="" type="checkbox"/>	<input type="checkbox"/>	
Zone 4	<input checked="" type="checkbox"/>	<input checked="" type="checkbox"/>	Wrong date
Zone 5	<input checked="" type="checkbox"/>	<input type="checkbox"/>	
Zone 6	<input checked="" type="checkbox"/>	<input type="checkbox"/>	
Zone 7	<input checked="" type="checkbox"/>	<input type="checkbox"/>	
Zone 8	<input checked="" type="checkbox"/>	<input checked="" type="checkbox"/>	Move down 6 points
Back to Start	<input type="checkbox"/>	<input type="checkbox"/>	

VisiDiff provides proofing automation for single and multiple page, multiple part, color and monochrome documents. The Adobe Acrobat Professional software is required on the PC running VisiDiff, but the VisiDiff Job Approval Form can be opened and used by anyone with the free Adobe Reader.

Using VisiDiff, a graphic designer can quickly:

- Detect all visual changes to nearly-identical PDF files from any source
- Build a Change Approval E-Form for Proofreaders to examine and OK changes
- Provide a proofreading audit trail for production workflow

